

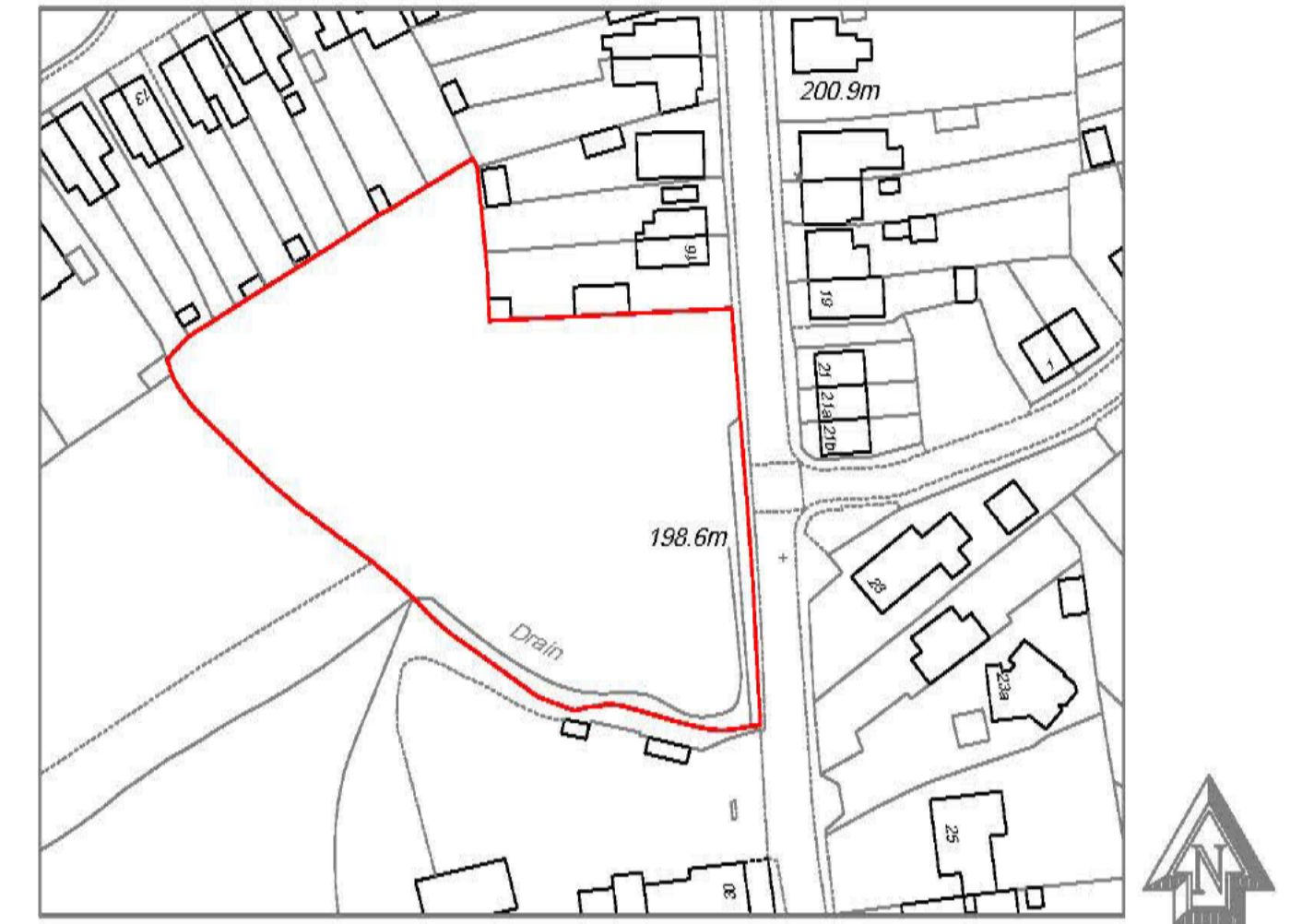

200.9m

Proposed Housing Site Location Plan  
 Proposed Residential Candidate Site At  
 Land Off Llannon Road, Upper Tumble - Carmarthenshire.  
 Scale - 1:1250



Key  
 PROPOSED SITE BOUNDARY

KEY TO SITE LAYOUT:

- PROPOSED TREE PLANTING 
- PROPOSED HEDGEROWS 
- EXISTING PERIMETER TREES RETAINED 
- PARKING AREAS 
- HIGHWAY 
- FOOTWAY 
- PROPOSED SITE BOUNDARY 
- PROPOSED SUDS AREAS 
- SHARED PRIVATE DRIVE 

KEY TO HOUSING:

HOUSE TYPE	TOTAL NUMBER
 A-Atom 2 Bed Link	6
 B-Banks 3 Bed Semi Detached-Pair	12
 C-Coute 3 Bed Detached	2



www.evansbanks.com

2 Llandello Road,  
 Cross Hands,  
 Carmarthenshire,  
 SA14 6NA

Project LDP Site Layout Plan	
Site Proposed Residential Candidate Site At Land Off Llannon Road, Upper Tumble - Carmarthenshire	
Drawing No 04-01	Revision
Date 08.04.2023	Scale 1:200 & 1:1250 @ A1