

Figure 3 – Site Constraints Plan

KEY:

- INDICATIVE PARC EMLYN OWNERSHIP BOUNDARY
- AREA SUITABLE FOR DEVELOPMENT SUBJECT TO SPECIFIC INVESTIGATION AND ASSESSMENT
- AREAS NOT SUITABLE FOR DEVELOPMENT UNTIL INVESTIGATION OR TREATMENT
- AREA PROBABLY SUITABLE FOR DEVELOPMENT SUBJECT TO FURTHER INVESTIGATION
- AREA OF PROCESSED JAPANESE KNOTWEED DEPOSITION AT DEPTH.
- SHAFT LOCATIONS
- TREATED SHAFT LOCATIONS
- OFF SITE SHAFT LOCATIONS
- ADIT POSITIONS
- TREATED ADIT POSITIONS
- OFF SITE ADIT POSITIONS

NOTE:

REFERS TO CONSTRAINTS PLAN WITHIN VALIDATION REPORT FOR FURTHER DETAIL.

OWNERSHIP BOUNDARY IS INDICATIVE ONLY AND IS SUBJECT TO CONFIRMATION.

NEW ROAD LAYOUT OVERLAYS FROM CARMARTHENSHIRE COUNTY COUNCIL GENERAL ARRANGEMENT PLAN PROJECT REF: 80/060/061 DWG REF: PEL-03 REV A DATED 24.10.15.

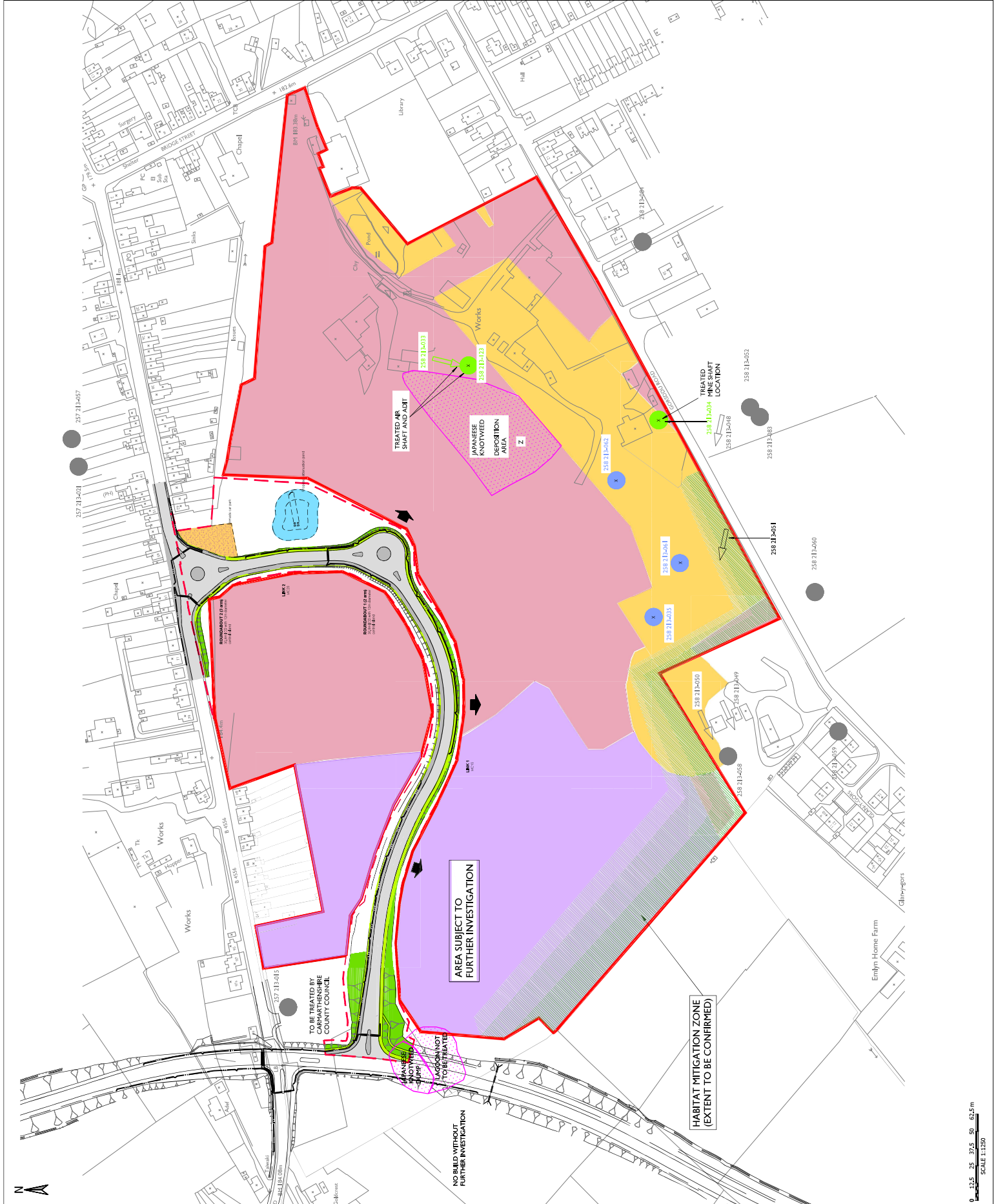

NO.	DATE	DESCRIPTION	BY	CHKD BY	APP'D BY
1	11.04.2012	ISSUE FOR DEVELOPMENT	PA	PA	PA
2	11.04.2012	ISSUE FOR DEVELOPMENT	PA	PA	PA
3	11.04.2012	ISSUE FOR DEVELOPMENT	PA	PA	PA
4	11.04.2012	ISSUE FOR DEVELOPMENT	PA	PA	PA
5	11.04.2012	ISSUE FOR DEVELOPMENT	PA	PA	PA
6	11.04.2012	ISSUE FOR DEVELOPMENT	PA	PA	PA
7	11.04.2012	ISSUE FOR DEVELOPMENT	PA	PA	PA
8	11.04.2012	ISSUE FOR DEVELOPMENT	PA	PA	PA
9	11.04.2012	ISSUE FOR DEVELOPMENT	PA	PA	PA
10	11.04.2012	ISSUE FOR DEVELOPMENT	PA	PA	PA

Tetra Tech staff
 Tetra Tech Ltd
 47 Newport Road, Cardiff
 CF11 6JG
 Tel: +44 (0)29 202 3000
 www.tetratech.co.uk

Document Control
 Version: 01
 Date: 11/04/2012

PARC EMLYN DEVELOPMENTS LTD
 PARC EMLYN

SITE CONSTRAINTS PLAN

NO.	DATE	DESCRIPTION	BY	CHKD BY	APP'D BY
1	22.02.2018	ISSUE FOR DEVELOPMENT	PA	PA	PA
2	22.02.2018	ISSUE FOR DEVELOPMENT	PA	PA	PA
3	22.02.2018	ISSUE FOR DEVELOPMENT	PA	PA	PA
4	22.02.2018	ISSUE FOR DEVELOPMENT	PA	PA	PA
5	22.02.2018	ISSUE FOR DEVELOPMENT	PA	PA	PA
6	22.02.2018	ISSUE FOR DEVELOPMENT	PA	PA	PA
7	22.02.2018	ISSUE FOR DEVELOPMENT	PA	PA	PA
8	22.02.2018	ISSUE FOR DEVELOPMENT	PA	PA	PA
9	22.02.2018	ISSUE FOR DEVELOPMENT	PA	PA	PA
10	22.02.2018	ISSUE FOR DEVELOPMENT	PA	PA	PA

0 15.5 25 37.5 50 62.5 m
 SCALE 1:1250