

A3

ORIGINAL
PLOT SIZE

COPYRIGHT RESERVED

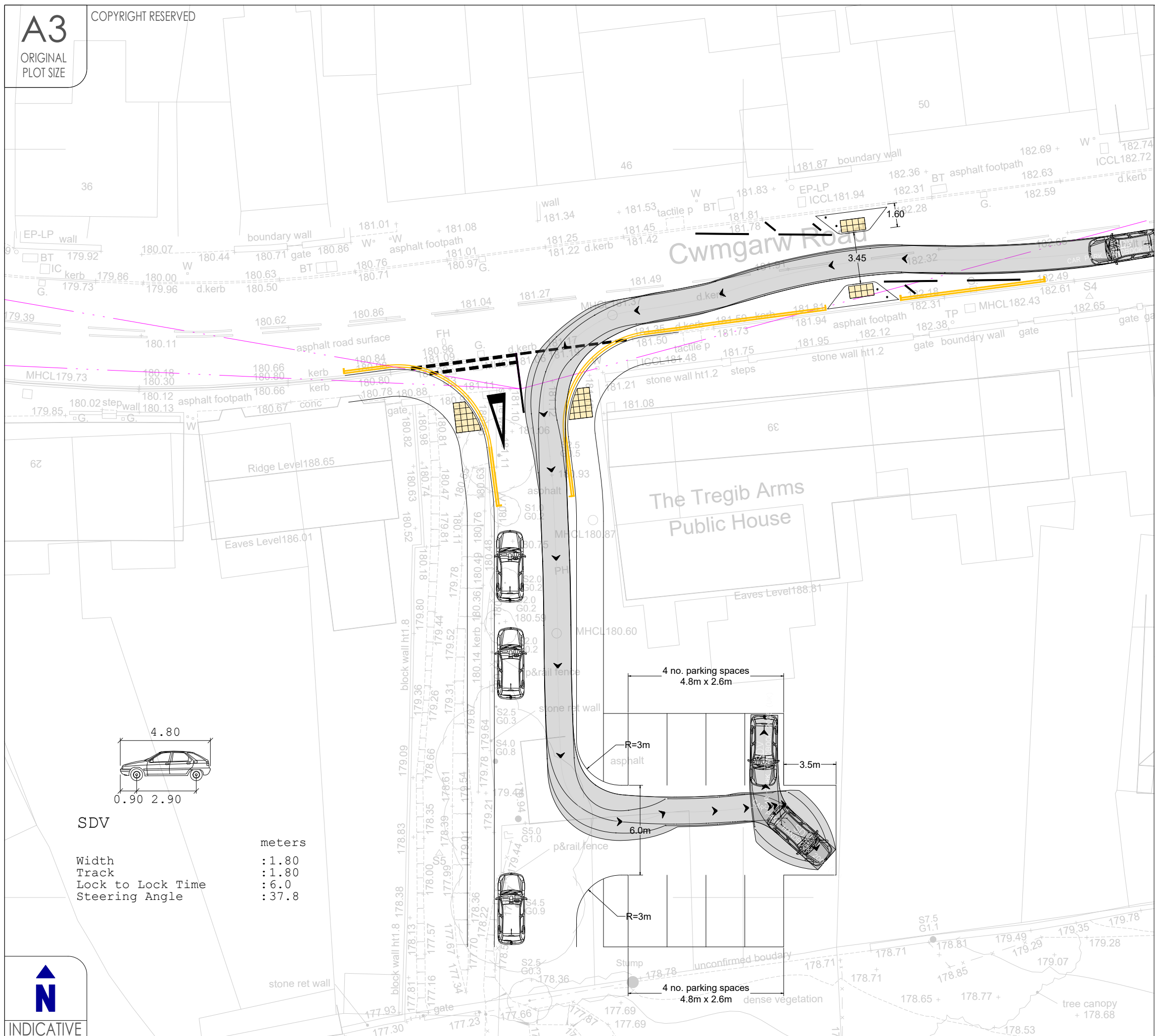

NOTES:

Reproduced from Ordnance Survey Superplan Data with the permission of The Controller of Her Majesty's Stationary Office. Crown Copyright - Licence No. AL100034021
This drawing is based on [Company's Name] Drawing No:

Rev	Date	Details	Drawn by	Checked by
B	03.11.22	Car park layout amended based on swept paths	MP	MA
A	21.10.22	Existing car park extended and access moved	MP	MA

CORUN
Transport and Highway Engineering

Corun Associates Ltd
Swansea
E swansea@corun.uk.com
W www.corun.uk.com

CLIENT:
MRS DYDLIKE AND MRS WIGHT

PROJECT:
LAND OFF CWMGARW ROAD
BRYNAMMAN

TITLE:
TREGIB ARMS
PROPOSED PARKING
ARRANGEMENT

STATUS:
PRELIMINARY

SCALE:	DATE:	DRAWN:	CHECKED:
1:250	07/22	MA	MA

JOB NO:	DRAWING NO:	REVISION:
20-00660	02	B