

A3

ORIGINAL PLOT SIZE

COPYRIGHT RESERVED

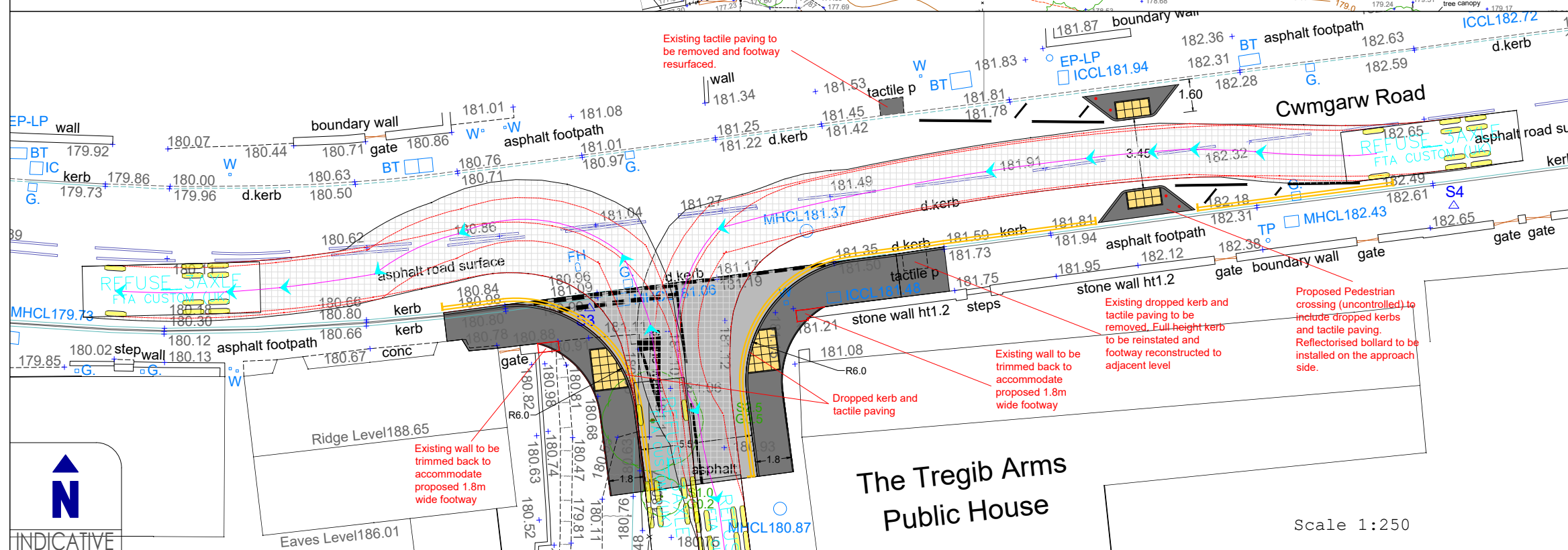
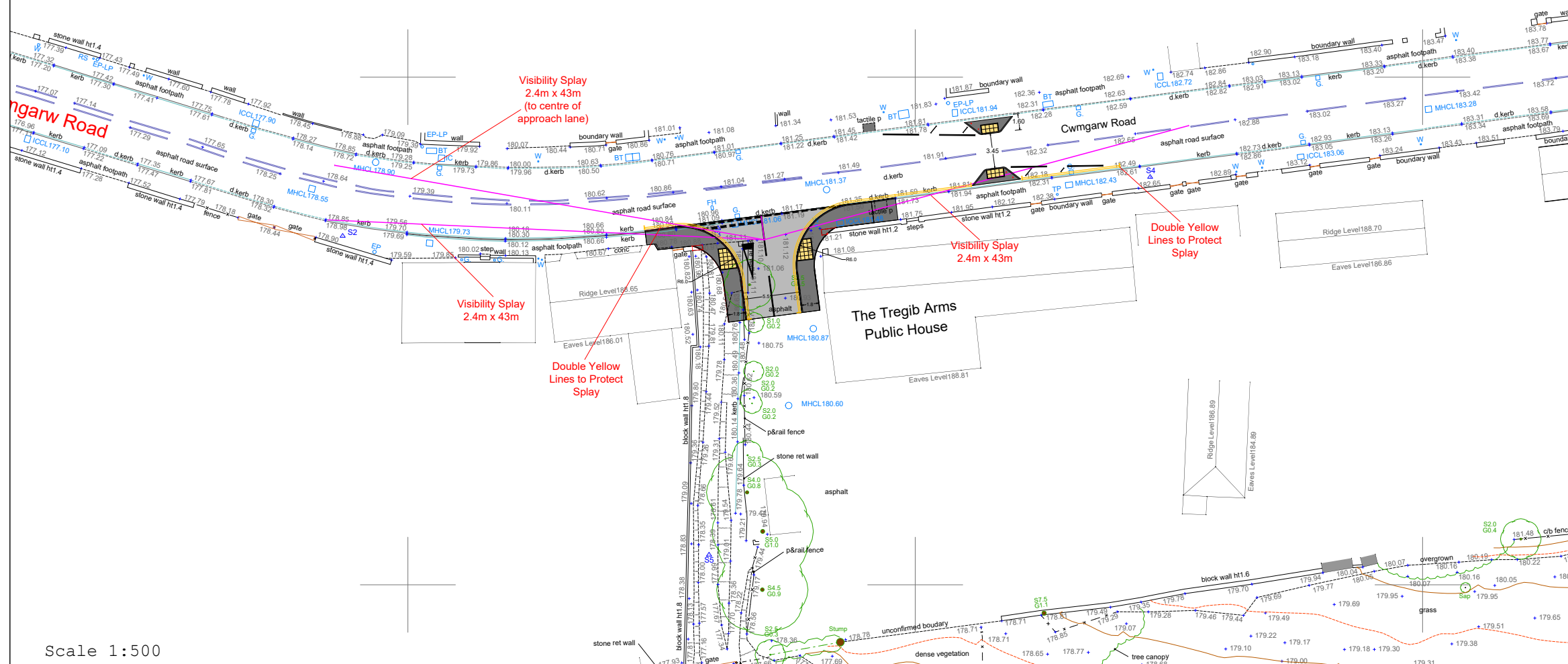

NOTES:

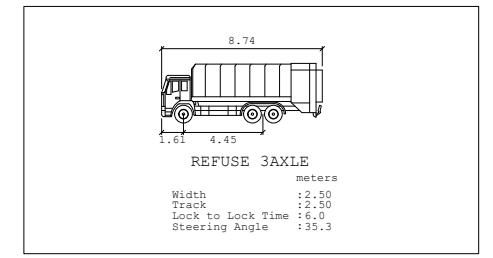

Reproduced from Ordnance Survey Superplan Data with the permission of The Controller of Her Majesty's Stationery Office. Crown Copyright - Licence No. AL100034021

This drawing is based on [Company's Name] Drawing No:

Rev	Date	Details	Drawn by	Checked by
C	JULY'22	PEDESTRIAN CROSSING ADDED	MA	MA
B	FEB'22	DOUBLE YELLOW LINES REDUCED IN LENGTH	MA	MA
A	DEC'20	DOUBLE YELLOWS ADDED - RSA STAGE 1 RESPONSE	MA	MA

**CORUN**  
 Transport and Highway Engineering

Corun Associates Ltd  
 Swansea  
 E swansea@corun.uk.com  
 www.corun.uk.com

CLIENT:  
MRS DYDLYKE AND MRS WIGHT

PROJECT:  
LAND OFF CWMGARW ROAD  
BRYNAMMAN

TITLE:  
PROPOSED WORKS  
PEDESTRIAN CROSSING

STATUS:  
PRELIMINARY

SCALE:	DATE:	DRAWN:	CHECKED:
AS SHOWN	11/20	MA	MA

JOB NO:	DRAWING NO:	REVISION:
20-00660	01	C

