

# Gors Goch Cottage

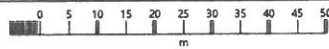

Plot 1, 2 a 5 Byngalo - 2 neu 3 ystafell wely  
 Plot 3 a 4 Tai fforddiadwy - 3 ystafell wely  
 Plot 6, 7, 8, 9, a 10 Plot Adeiladu - Tŷ 3 neu 4 ystafell wely



Gors Goch Cottage,  
 Black Lion Road,  
 Gorslas,  
 SA14 6RT

OS MasterMap 1250/2500/10000 scale  
 Monday, February 19, 2018, ID: BW1-00691459  
 maps.blackwell.co.uk

1:1250 scale print at A4, Centre: 257515 E, 213111 N

©Crown Copyright Ordnance Survey. Licence no. 100041041



# Gors Goch Cottage

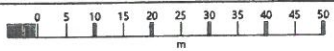
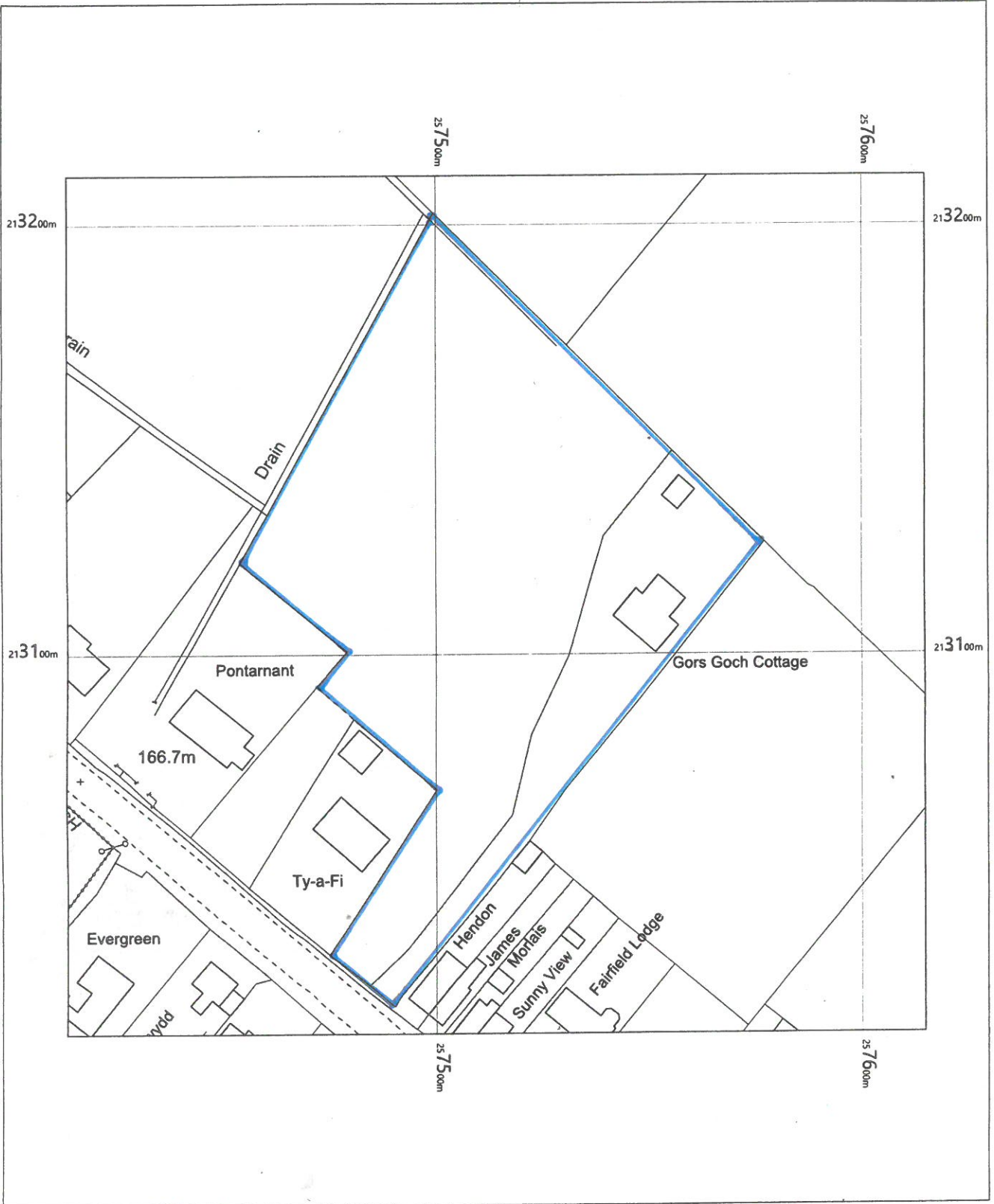

Gors Goch Cottage,  
Black Lion Road,  
Gorlas,  
SA14 6RT

OS MasterMap 1250/2500/10000 scale  
Monday, February 19, 2018, ID: BW1-00691459  
maps.blackwell.co.uk  
  
1:1250 scale print at A4, Centre: 257515 E, 213111 N  
©Crown Copyright Ordnance Survey. Licence no. 100041041



# Gors Goch Cottage

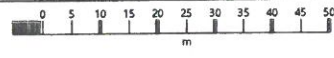
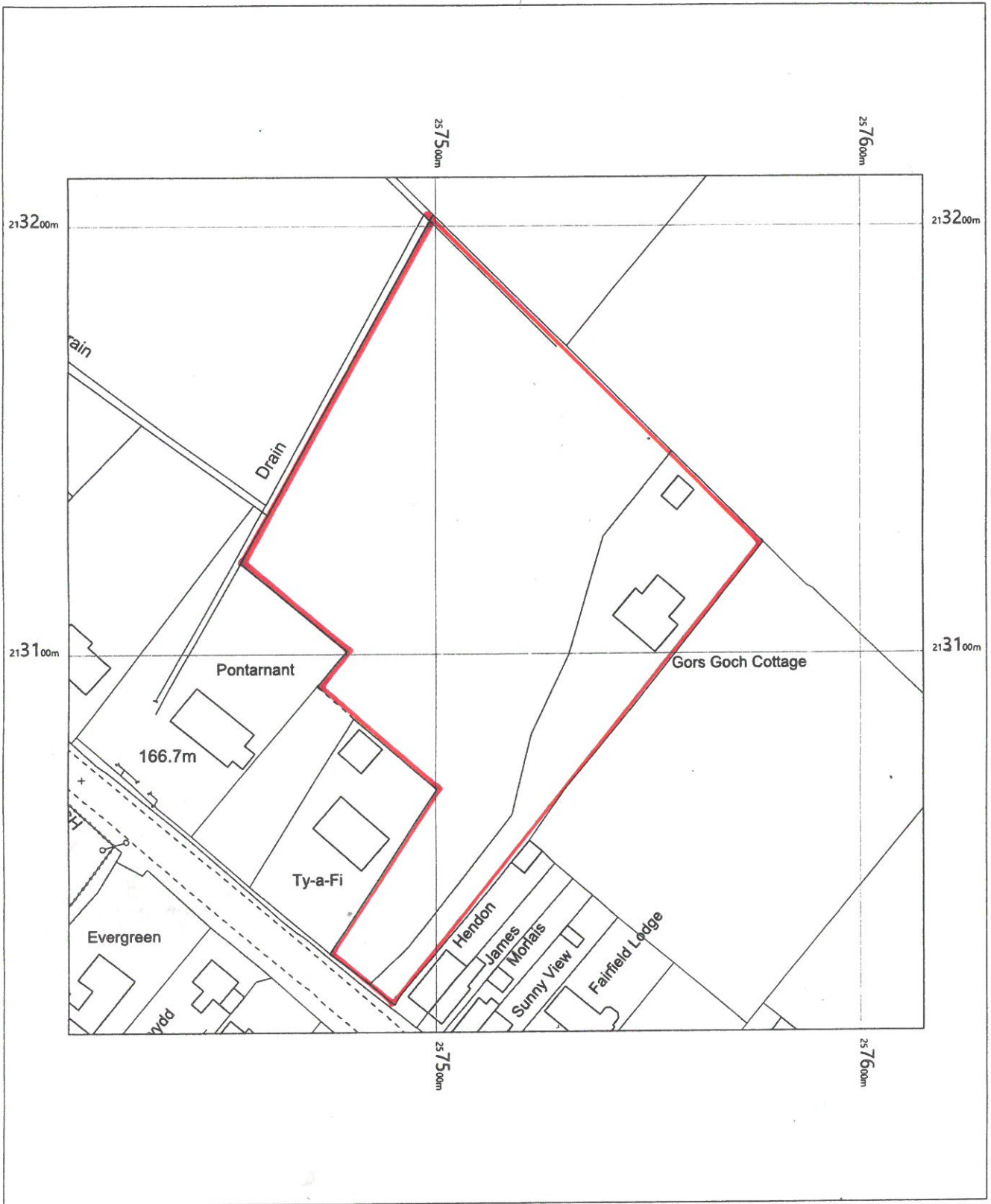

Gors Goch Cottage,  
Black Lion Road,  
Gorslas,  
SA14 6RT

OS MasterMap 1250/2500/10000 scale  
Monday, February 19, 2018, ID: BW1-00691459  
maps.blackwell.co.uk  
  
1:1250 scale print at A4, Centre: 257515 E, 213111 N  
  
©Crown Copyright Ordnance Survey. Licence no. 100041041



# Gors Goch Cottage

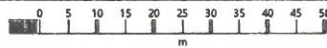
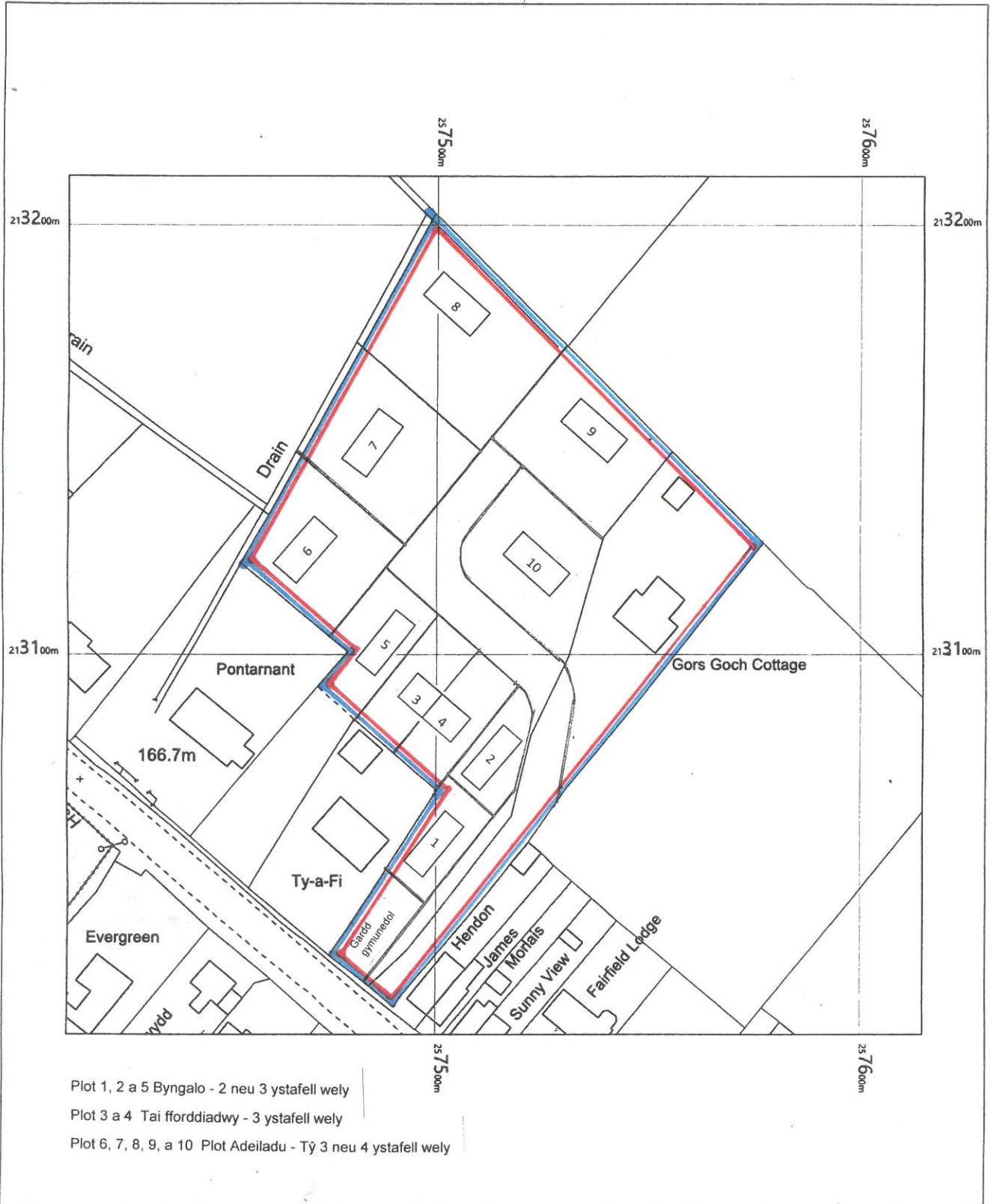

Gors Goch Cottage,  
 Black Lion Road,  
 Gorslas,  
 SA14 6RT

OS MasterMap 1250/2500/10000 scale  
 Monday, February 19, 2018, ID: BW1-00691459  
 maps.blackwell.co.uk

1:1250 scale print at A4, Centre: 257515 E, 213111 N

©Crown Copyright Ordnance Survey. Licence no. 100041041



Map 5 Lleoliad - Ffiniau Parc Cyflogaeth Cross Hands i gymharu a fy nghynllun arfaethedig

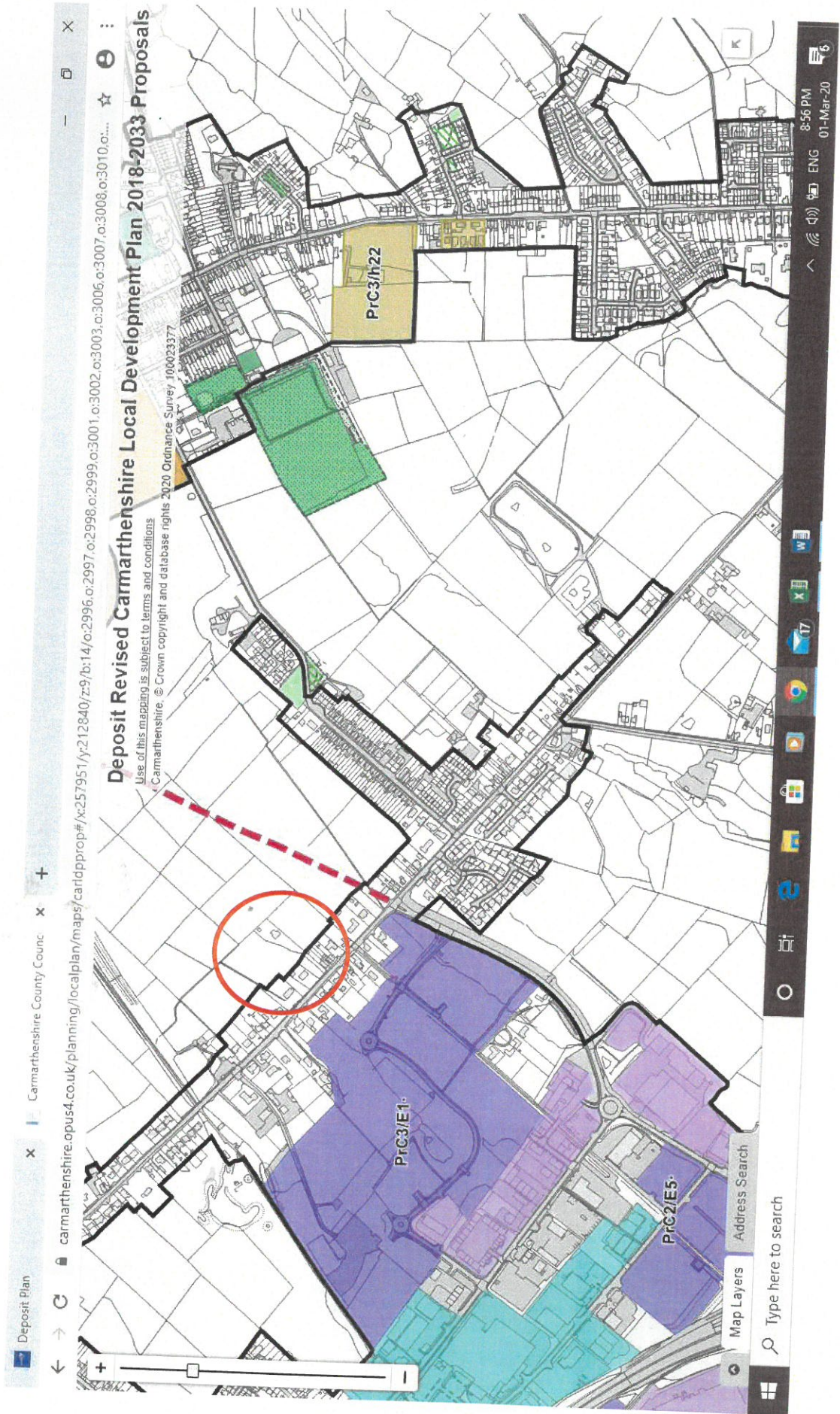

Map 6 Ffotograff o ffiniau Parc Cyflogaeth Cross Hands i gymharu a fy nghynllun arfaethedig

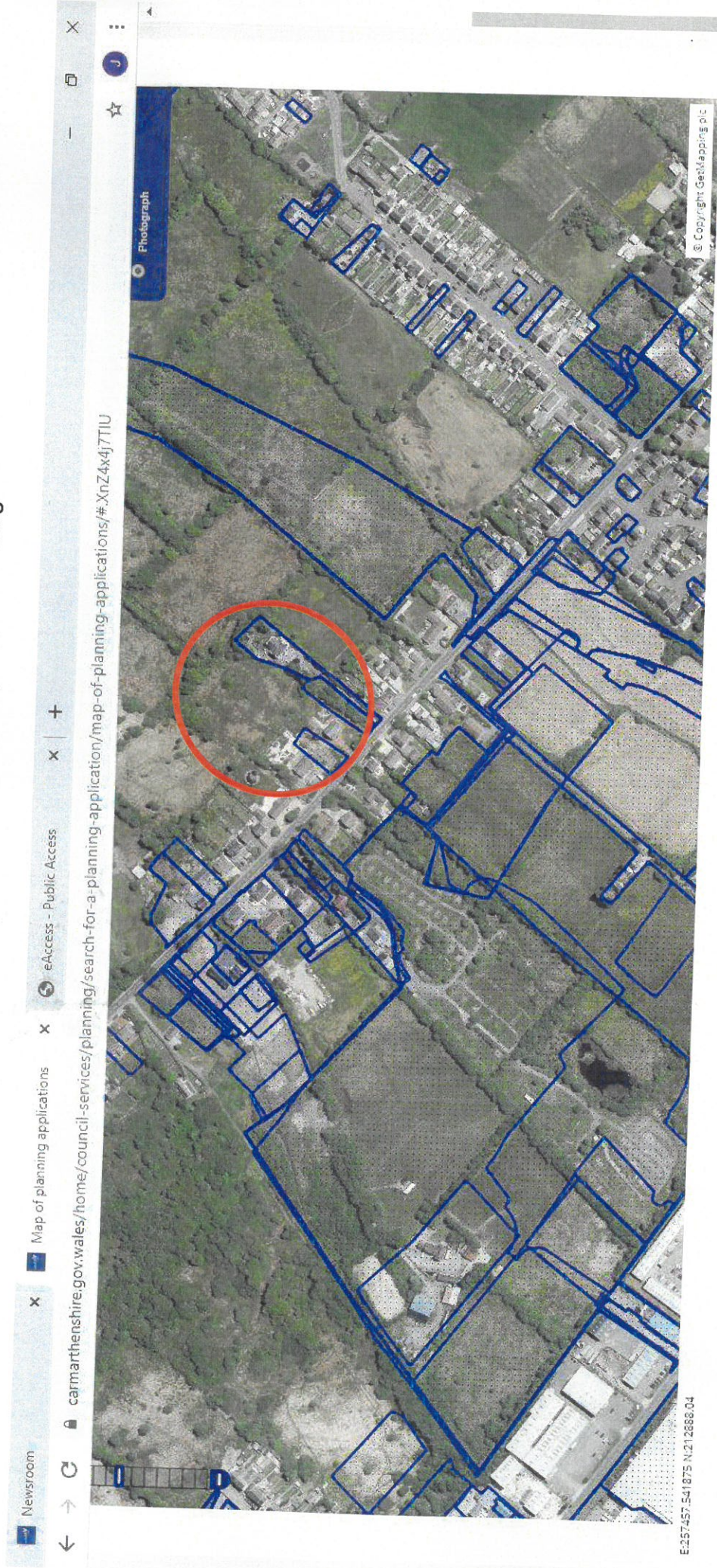

MORE FROM PLANNING

## Map 7

Sy'n dangos fod y sir wedi rhoi caniatad Cynllunio i'r ardal melyn (E/36671), sydd llai na 100 metr oddi wrth yr ardal rydw i'n ceisio cael eu hystyried yn Cynllun Datblygu'r Sir 2018-2033



Map 8 – Sy'n dangos lleoliad yr heol newydd i gymharu a'r cynllun arfaethedig

← → ↻ 📍 📱 🗺️ 📄 📌 🌟 📄

Apps

Use of this mapping is subject to terms and conditions

© Crown copyright and database rights 2020 Ordnance Survey 100023377

© Carmarthenshire

Man I awers Address Search

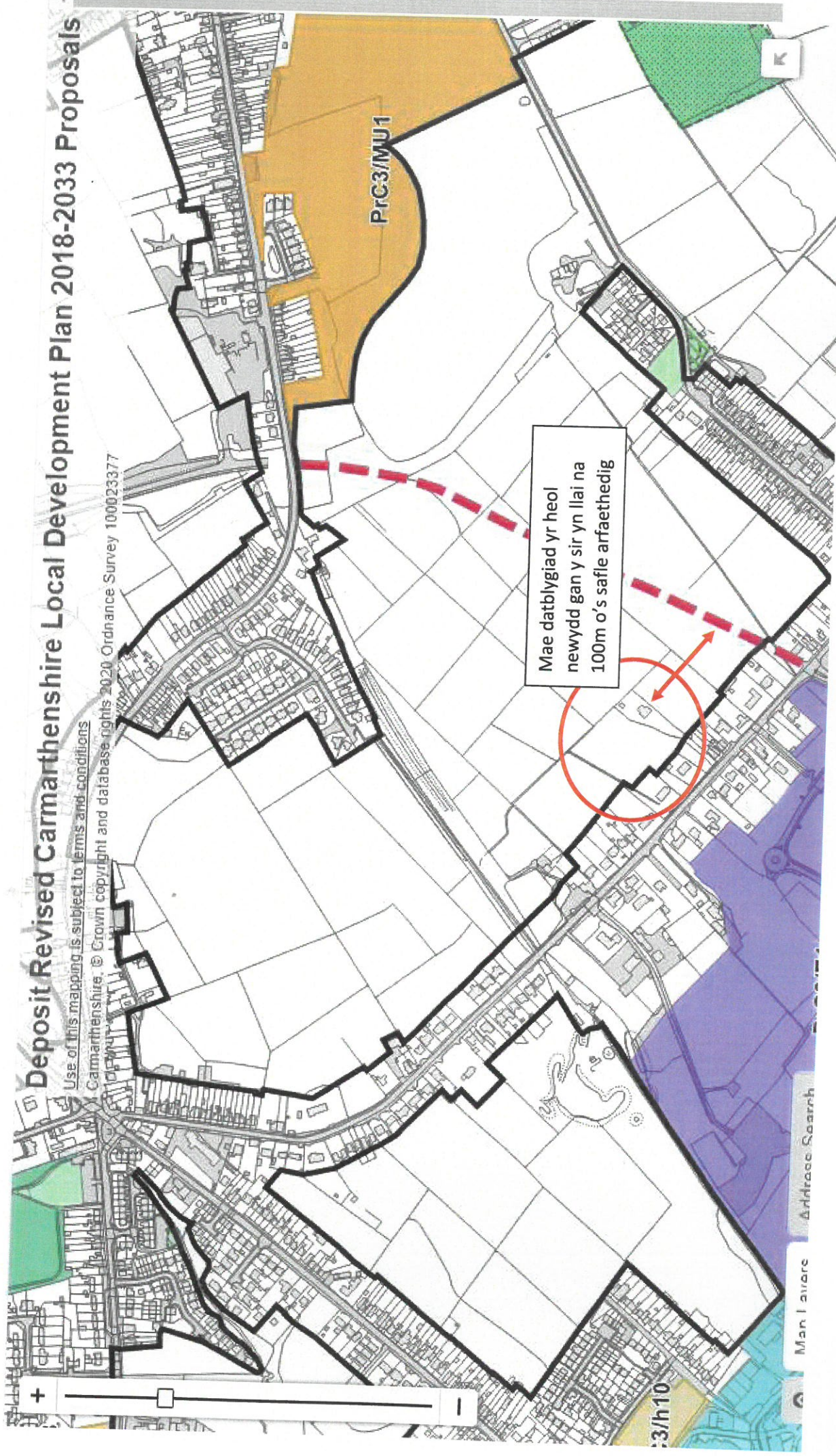



Map 9 Arosfa Bysys Cyfagos

Journey planner | South & West ✕ [Bus Stop Finder](#)

← → ↻ 📍 traveline.cymru/bus-stop-finder/

✎ + [✕](#) [📁](#) [🏠](#) [⌵](#) [🌐](#)

Customise My Journey

Call us: 0800 464 00 00

Accessibility [🔽](#) | Cymraeg | [f](#) | [t](#) | [+](#)

Journey Planner Timetables Disruptions **Bus Stop Finder** Departure Boards Travel Info

**trav**eline.cymru

**Bus Stop Finder**

Find your bus stop and next bus

**Adverse Weather Travel Information** - Please click here >

The map displays the Eifionydd region with several bus routes and bus stop markers. Red circular markers with arrows indicate bus stop locations, while blue location pins mark specific points of interest. A yellow road with the number B4556 is visible. Landmarks include Gorslas Primary School, Rees Roger, Wyn Bishop Funeral Director &..., Highfield Pine & Oak furniture, and Maes-Y-Lili Vintry. Roads shown include Cefnarthin Rd, Cross Hand, Black Lion Rd, and Eifionydd Rd. A river, the Afon Eifionydd, flows through the area.